

# Chassis Quick Reference

## Major Components

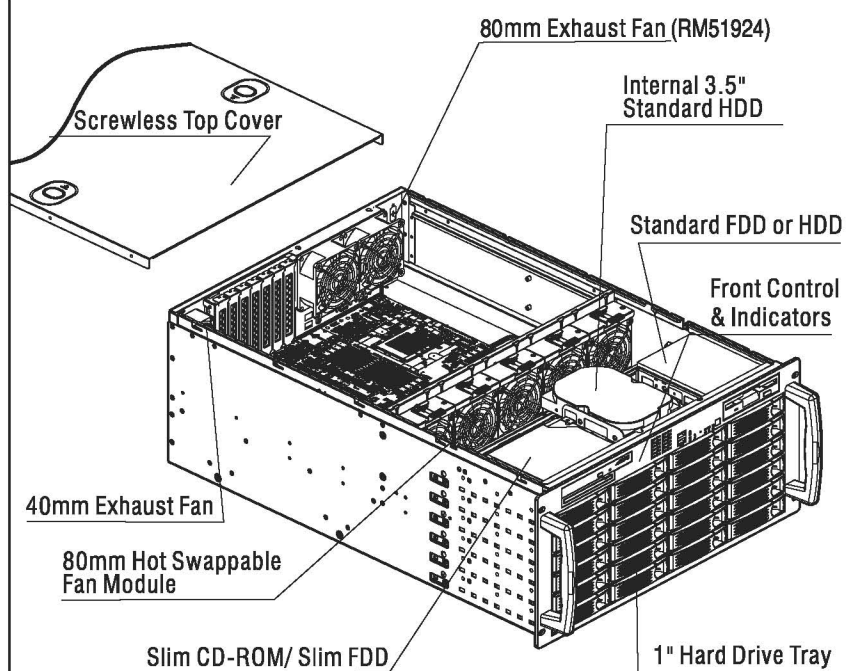

## Front Panel Controls and Indicators

- A. HDD Tray Activity LED
- B. USB 2.0 Port
- C. LAN1 & LAN2 LED
- D. Alarm Mute Button
- E. System Reset Button
- F. Failure LED
- G. System HDD Activity LED
- H. Power LED
- I. Power Button

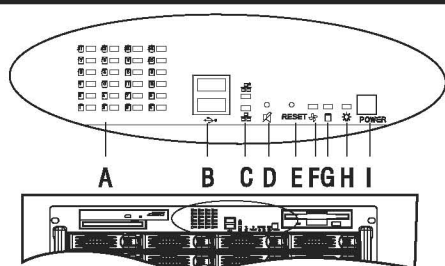

## Rear Window Configuration

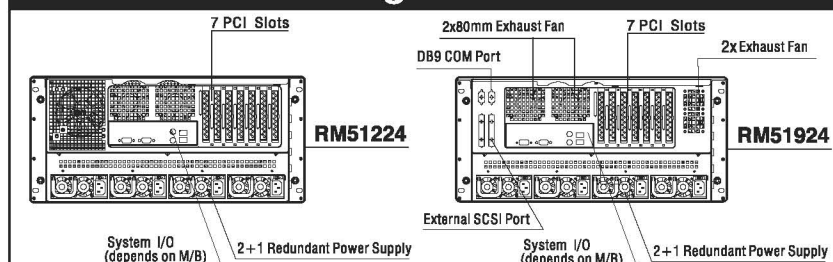

## Top Cover Opening

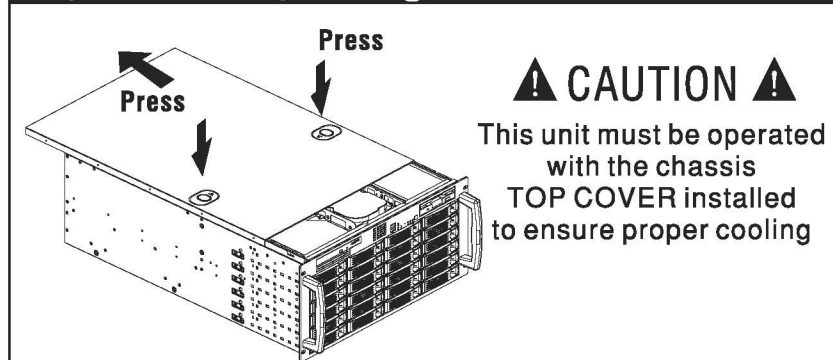

## Installing Hard Drive

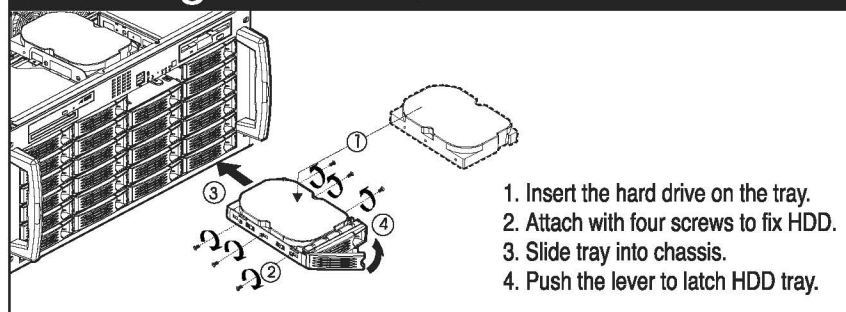

## Moving Hot Swappable Fan Module

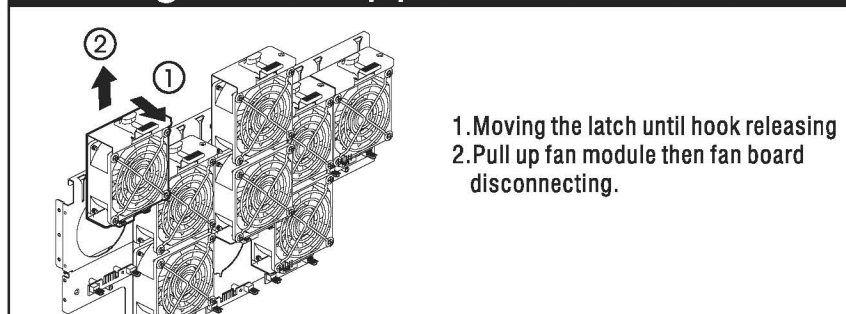

## Moving Power Supply Cage Module

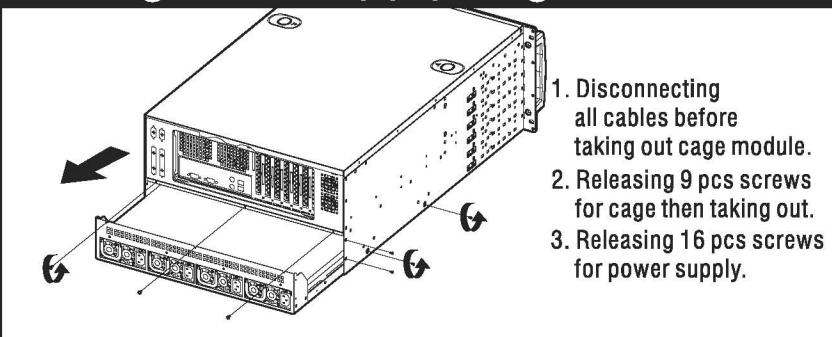

## Moving Main Board Cage Module

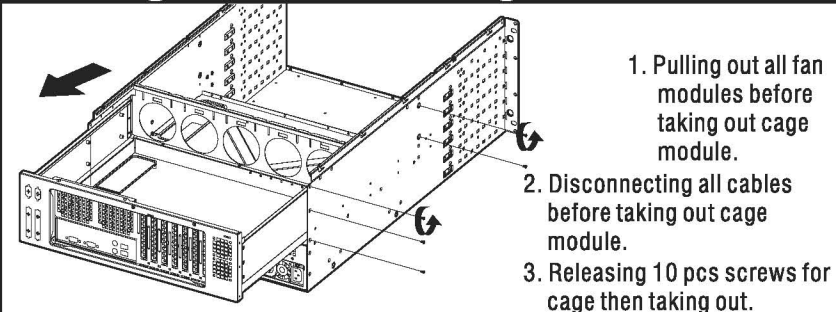

## Installing Slim HDD & Slim FDD

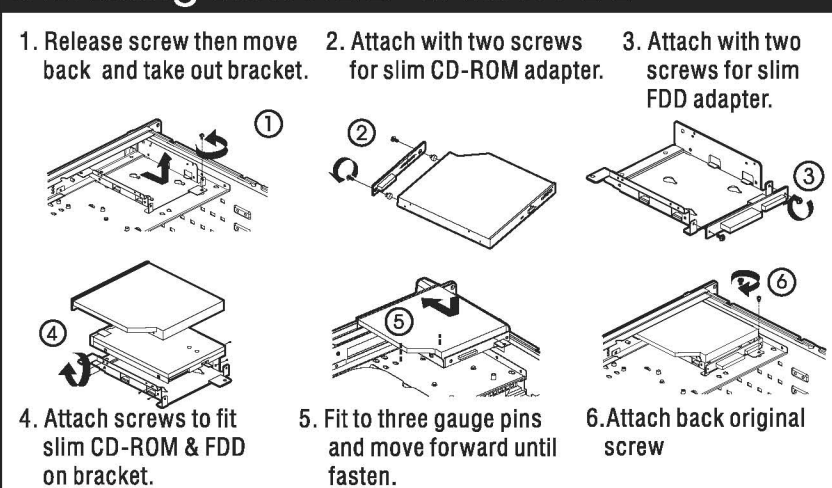

## Installing Internal HDD & FDD

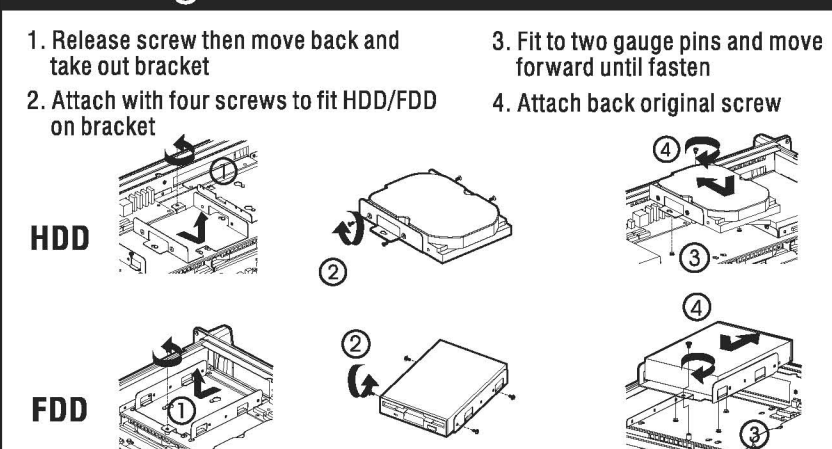

## Installing Backplane Assembly

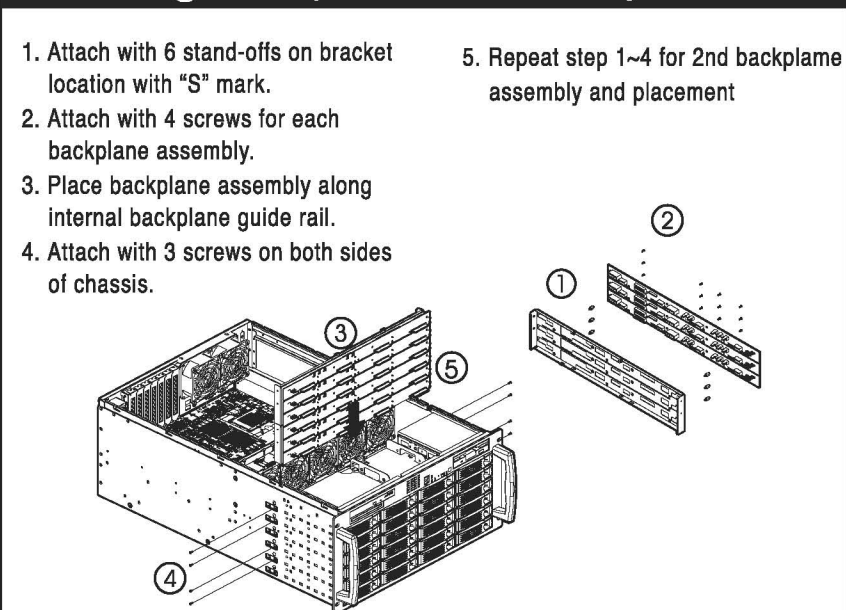

364.0 mm